

# 2025 MASTER FLOOR PLAN



**EXPO** Showing Others  
Healthy Options

Sept. 4 - Sept. 7 2025

## BOOTH PRICES & INFORMATION

Booth Fees 10' x 10':

**P \$2800**

**A \$2600**

**B \$2200**

Booth Fees 5' x 10':

**E \$1800**

10' x 10' (P, A, B)

**Full Booth Purchase Includes:**

Carpet, (2) chairs, 6' draped (white) table, wastebasket, sign and free listing in Show Program or Addendum (print deadlines apply) and more. Booth and aisle carpet - show colors only.

5' x 10' (E)

**For Companies with 20 products or less**

**Half Booth Purchase Includes:**

(2) Chairs, 4' draped (white) table and additional items listed above for Booths P, A, B

\*Brokers limited to 1 half booth

**New Market Square Pavilion**

**First Time Exhibitors**  
15 items or less

**6' Table Top Display Area**  
**\$1200**  
Restrictions apply. Call for details.

**BLDG. LEGEND:**

**FIRE LEGEND**  
FE - FIRE EXTINGUISHER  
FA - FIRE ALARM PULL SWITCH  
FS - FIRE STROBE (7' ELEVATION)  
FHC - FIRE HOSE CABINET

⊕ ⊙ ⊛ TYPICAL COLUMNS  
□ ELECTRICAL FLOOR PANEL

**SHOW UPDATES**  
**SOHOexpo.net**  
Facebook.com/SOHOexpo  
Twitter @SOHOexpo

**CONTACT US**  
727-846-0320  
Fax: 800-828-7250  
Email: info@SOHOexpo.net  
5946 Main Street  
New Port Richey, FL 34652

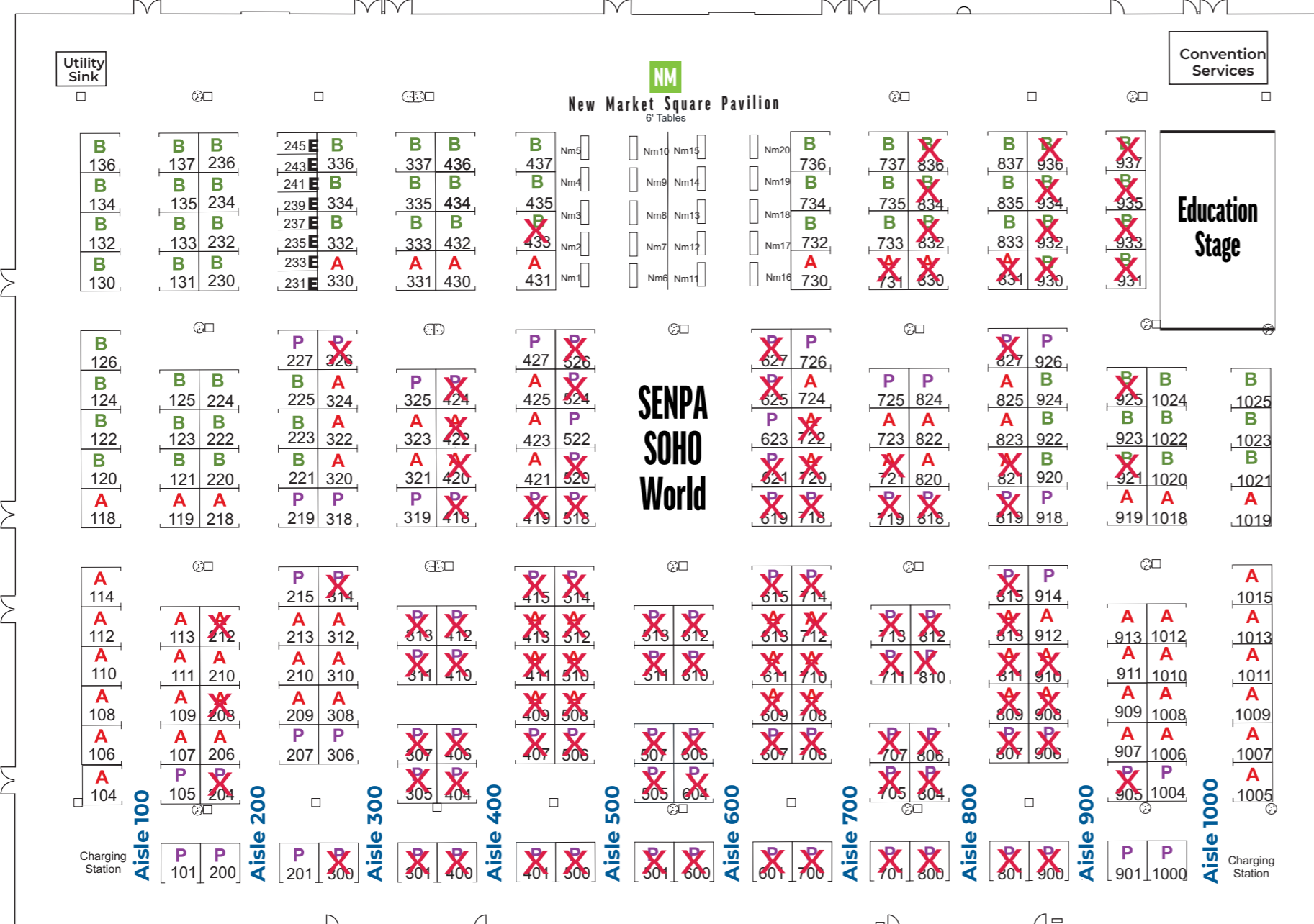

Utility Sink

NM

Convention Services

**New Market Square Pavilion**  
6' Tables

Education Stage

**SENPA SOHO World**

Charging Station

Charging Station

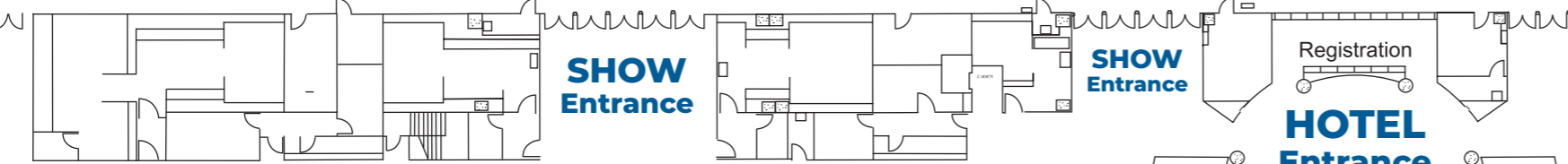

**BLDG. LEGEND:**

**FIRE LEGEND**  
FE - FIRE EXTINGUISHER  
FA - FIRE ALARM PULL SWITCH  
FS - FIRE STROBE (7' ELEVATION)  
FHC - FIRE HOSE CABINET

⊕ ⊙ ⊛ TYPICAL COLUMNS  
□ ELECTRICAL FLOOR PANEL

Floor plan subject to change in order to enhance the show.